

Cable Carrier T50.50

Produced in Nylon - Standard color: Black;
Temperature range: -30° ~120°c;

Opening system that facilitates changes and
maintenances of the cables and hoses.

Model with cables separator;

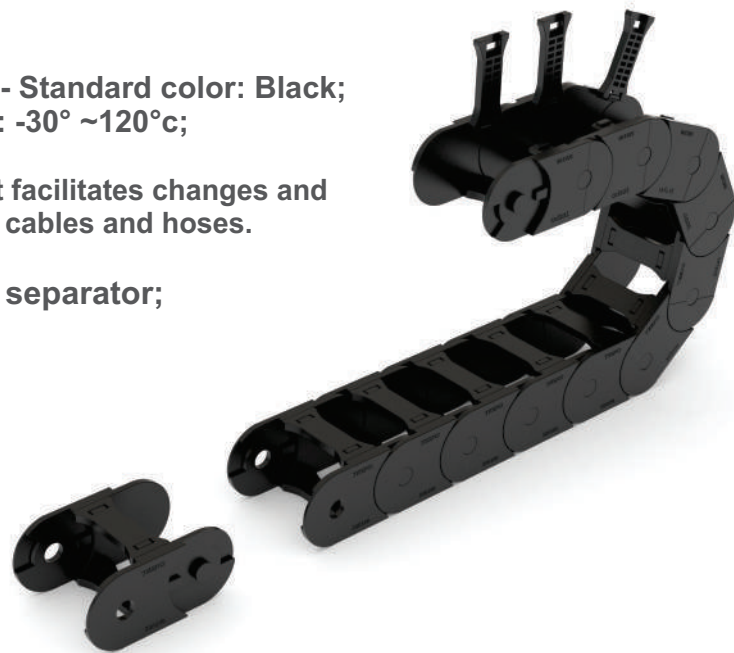

Technical Specifications

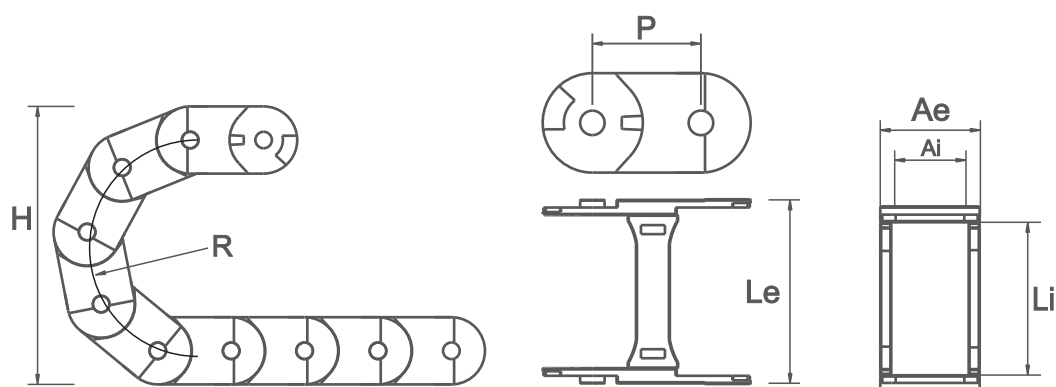

CODE	DESCRIPTION	INNER DIMENSIONS (Li x Ai)	EXTERNAL DIMENSIONS (Le x Ae)	HEIGHT (H)	RADIUS (R)	PITCH (P)	LINKS/ METRO	WEIGHT/ METRO
03703	CABLE CARRIER T50.50.R100mm	50X50	72X65	270	100	71	14	1780gr
03704	CABLE CARRIER T50.50.R150mm	50X50	72X65	370	150	71	14	1780gr

Mounting bracket

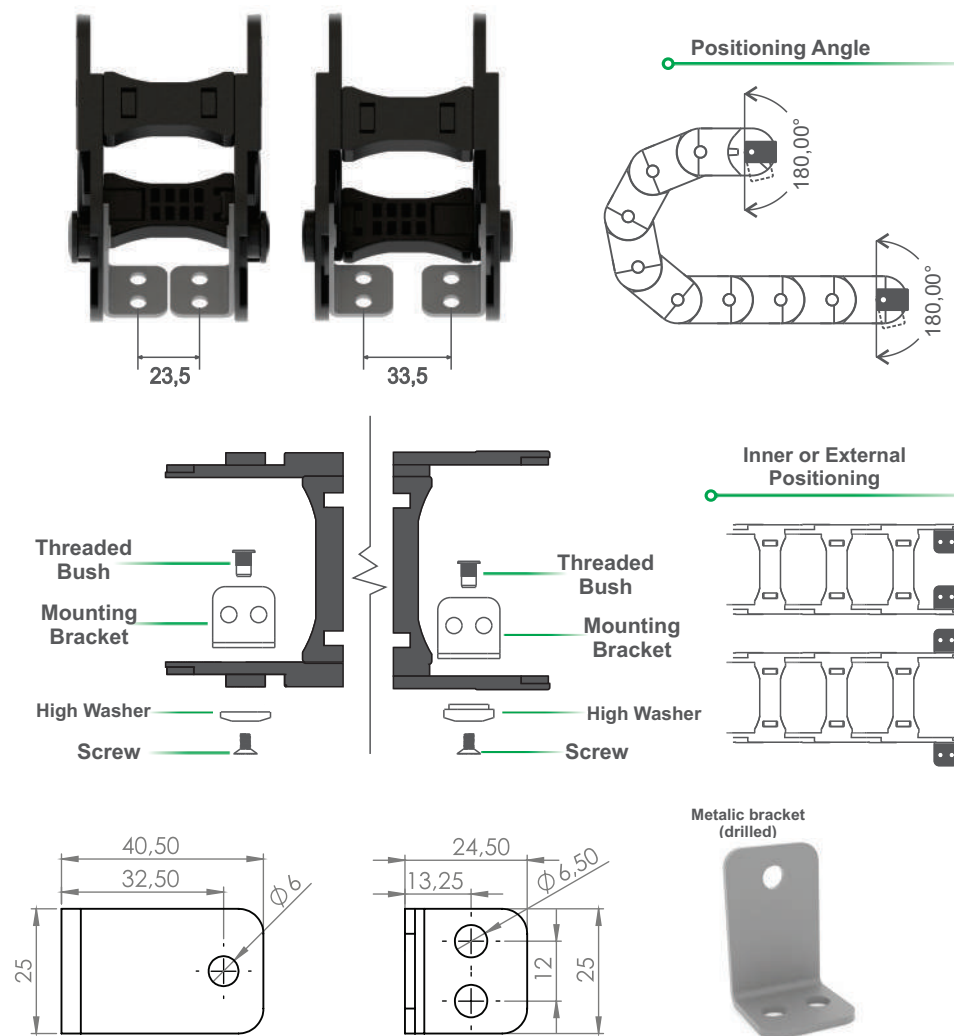

CODE	DESCRIPTION	INNER DIMENSIONS (Li x Ai)	EXTERNAL DIMENSIONS (Le x Ae)
03702	MOUNTING BRACKET SET	50X50	79X65

*Unit of measurement: milimeters

Cables Separator (Cód. 03558)

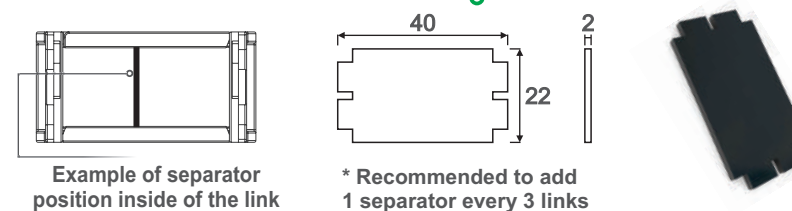

Assembly Plan

Step 1



Step 2

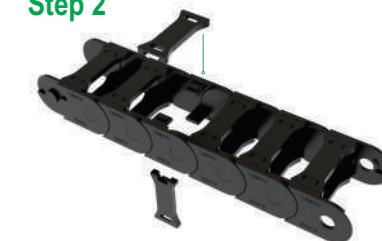

Step 3



Final Assembly

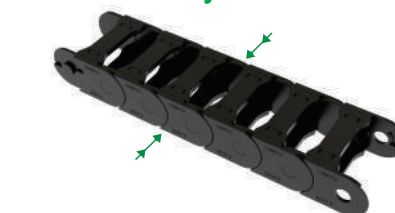

*Optional wrench is available to help during assembly process (Cód.03684)

